

Lab Analysis Working Group Update

- SEABOX: Builds custom CONEXEs
- Full field laboratory set-up
 - 3 gamma-spec detectors
 - 2-3 gross alpha/beta counters
 - HVAC
 - Lab hood for sample prep
 - Equipment storage/shipment
 - Power generator
 - Desks/tables/chairs
 - Secure access

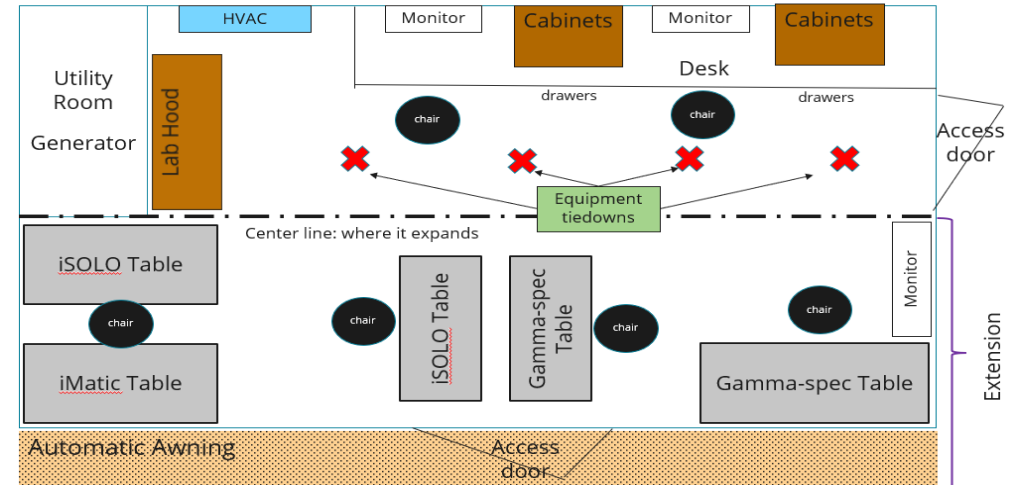
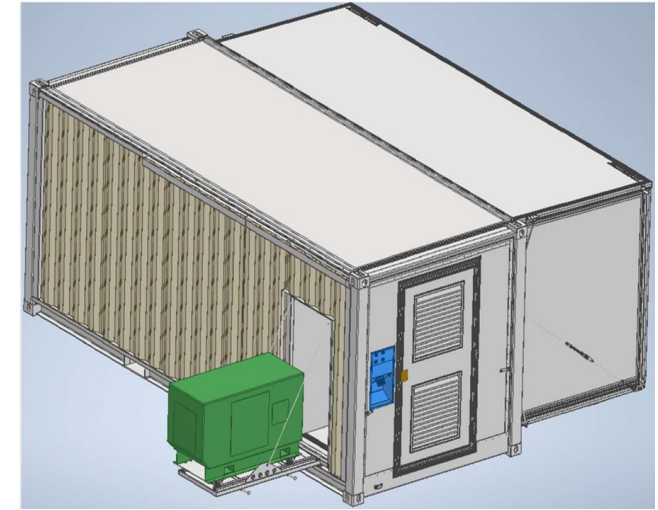
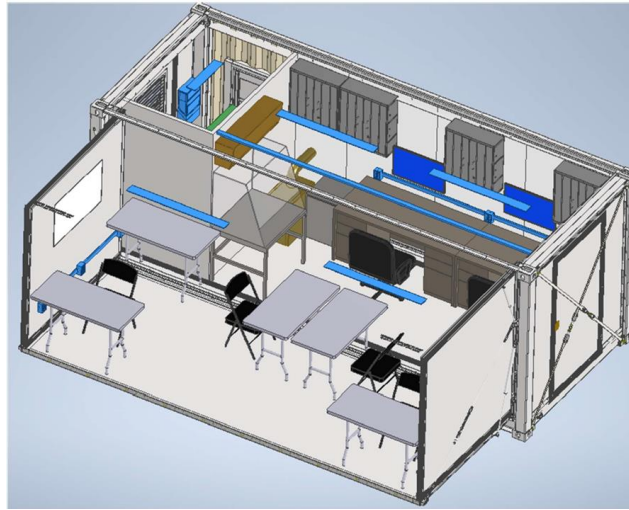

Workspace/utility layout

Lab Analysis Working Group Update

- Bison lifts: lifts/lowers lab in the field
- Contract hot shot truck for rapid, on-call deployment
- Permanently set up at SNL RAPROC
 - On-site quick turn around time lab
 - Ease of maintenance
 - Training opportunities
- Estimated Delivery: April 2026



Bison lifts



Semi-truck or aircraft delivery

Lab Analysis Working Group Update



- CBRN Responder Laboratory Participation Effort
 - Many States have radioanalytical laboratories to support their programs that have a “State” account type in CBRN Responder.
 - To interact with FRMAC Laboratory Analysis Group in an event, a laboratory must have a “Laboratory” account type to enable it to access to the CBRN Responder laboratory portal. The portal facilitates electronic transfer of information, completed forms and data packages to reduce/eliminate manual entry of data.
 - Currently there are only ~20 state laboratories that have the “Laboratory” type account that will allow electronic interface with FRMAC.